

LCI2 Upgrade Kit Installation Instructions

SUPERSEDES: New

EFFECTIVE: June 9, 2011

Overview

This upgrade kit provides the necessary parts to install the latest firmware and controller profiles onto an LCI2. The following sequences detail the process of upgrading an LCI2.

Kit Contents

- One Secure Digital (SD) Memory Card - Contains LCI2 Firmware
- One Compact Flash (CF) Memory Card - Contains controller profiles



The information on the SD card is in a proprietary format. The SD card cannot be read by a Windows PC. Please do not attempt to view or change the files on the SD card, as the LCI2 firmware may become unusable.

Upgrading the LCI2 Firmware and Controller Profiles

Installing Memory Cards

1. Disconnect power from the LCI2.
2. Remove the front access panel from the LCI2.
3. Locate the SD memory card slot, J3. It is located on the left hand side of the bottom-most PC board, below the notch to the right of the Ethernet port. See Figure 1.
4. Insert the SD memory card into the SD card slot. Make sure that the shiny contacts on the SD card are facing down, with the notched edge away from the installer. See Figure 2.
5. Push the SD memory card until it stops and is fully inserted into the SD card slot.
6. Locate the CF memory card. It is directly below the LON connection and Service Pin Button. See Figure 1.
7. Remove the existing CF memory card. Note the orientation of the CF card. See Figure 2.
8. Insert the new CF memory card provided in the upgrade kit into the LCI2. Gently push the CF memory card until it is firmly seated in the CF card socket.

Performing the Upgrades

1. Locate the LCI2 Service Pin Button.
2. Push and hold the LCI2 Service Pin Button while applying power to the LCI2.
3. The LCI2 will display the XStream Bootloader dialog box. This dialog has three buttons: Reset to Factory Defaults, Upgrade Firmware, and Exit.
4. Press the Upgrade Firmware button.
5. Press the Start button on the following screen to begin the upgrade process.
6. The LCI2 will show the status of the update by displaying the following in sequence: Reading Card, Erasing Flash, Writing Flash, and Verifying Flash.
7. When the upgrade process is complete, the LCI2 will display: Upgrade Complete - Remove Card.

Finishing the Job

1. Remove the SD memory card (see Figure 1). Do not power off the LCI2.
2. The LCI2 will display the XStream Bootloader dialog box. This dialog has three buttons: Reset to Factory Defaults, Upgrade Firmware, and Exit.
3. Press the Exit button to reboot the LCI2.
4. The upgrade process is complete. When the LCI2 reboots, it is ready for use.

Reference Figures

Figure 1: Memory Card Position Reference

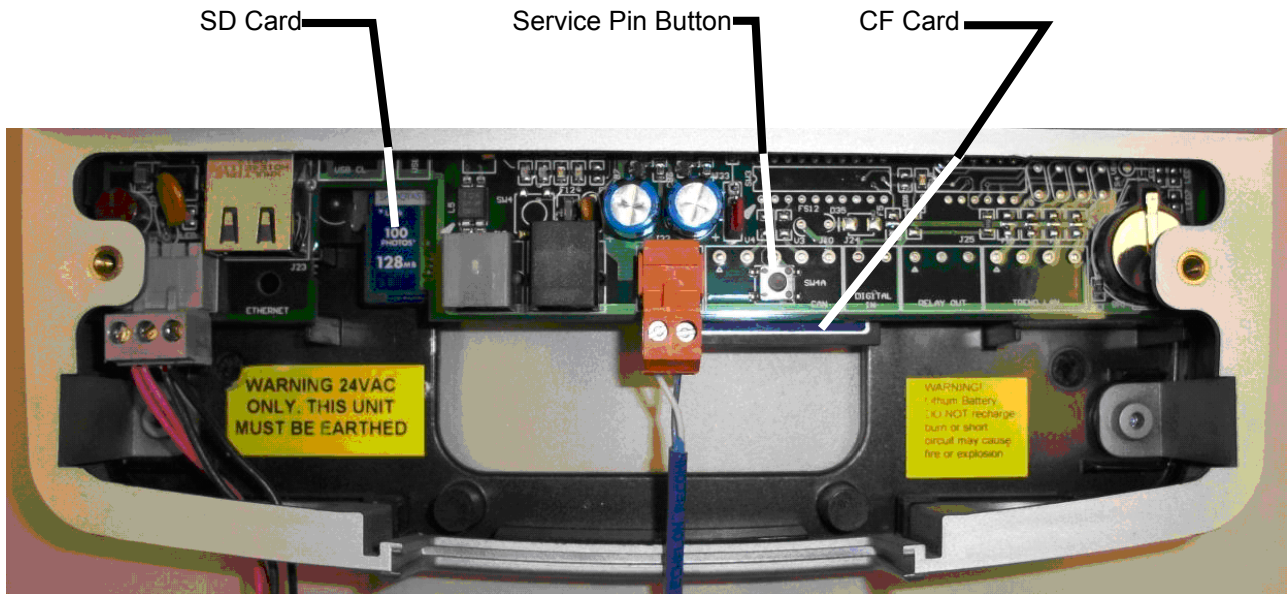
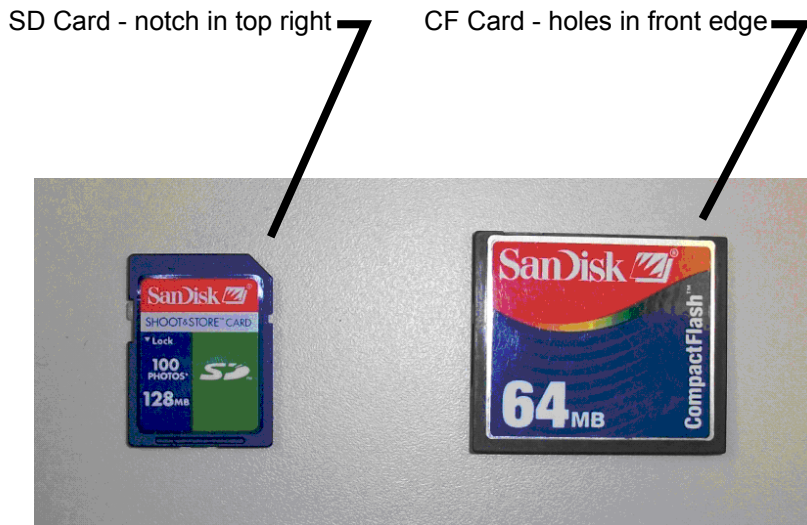

Figure 2: Memory Card Orientation Reference



Notes:

CONTROLS MADE EASY®

Taco Electronic Solutions, Inc., 1160 Cranston Street, Cranston, RI 02920
Telephone: (401) 942-8000 FAX: (401) 942-2360.

Taco (Canada), Ltd., 8450 Lawson Road, Unit #3, Milton, Ontario L9T 0J8.
Telephone: 905/564-9422. FAX: 905/564-9436.

Taco Electronic Solutions, Inc. is a subsidiary of Taco, Inc.
Visit our web site at: <http://www.taco-hvac.com>