

# Submittal Data Information

## U Tube Heat Exchangers

201-016

EFFECTIVE: JULY 25, 2018

SUPERSEDES: APRIL 15, 1995

22" DIAMETER LIQUID

Job: \_\_\_\_\_

Item No	Model No	Pass	GPM Tubes	Temp. In	Temp. Out	P.D. Tubes	Vel. Tubes	GPM Shell	Temp. In	Temp. Out	P.D. Shell	Vel. Shell

Tube Fluid \_\_\_\_\_ Shell Fluid \_\_\_\_\_

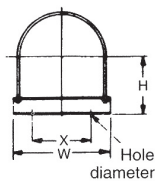

**SADDLES**  
(Optional)

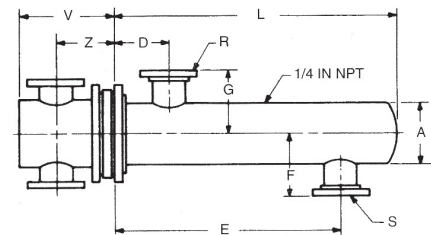
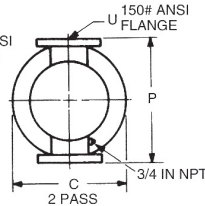
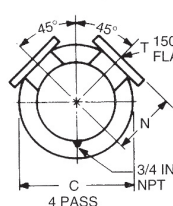

Model Number		Fabricated Steel Heads								Dimensions (inches)										Heating Surface (sq. ft.)	Shipping Weight (lbs.)
2 Pass	4 Pass	2 Pass				4 Pass				2 and 4 Pass											
		P	U	V	Z	N	T	V	Z	A	C	D	E	F	G	L	R	S			
G22208L	G22408L	35	10F	26 1/2	17 3/4	17 1/4	8F	25 5/8	17	22	29 1/2	11 1/2	34 3/8	17 1/2	17 1/2	48 1/2	10F	10F	241.6	1396	
G22210L	G22410L	35	10F	26 1/2	17 3/4	17 1/4	8F	25 5/8	17	22	29 1/2	11 1/2	46 3/8	17 1/2	17 1/2	60 1/2	10F	10F	313.0	1580	
G22212L	G22412L	35	10F	26 1/2	17 3/4	17 1/4	8F	25 5/8	17	22	29 1/2	11 1/2	58 3/8	17 1/2	17 1/2	72 1/2	10F	10F	384.5	1764	
G22214L	G22414L	35	10F	26 1/2	17 3/4	17 1/4	8F	25 5/8	17	22	29 1/2	11 1/2	70 3/8	17 1/2	17 1/2	84 1/2	10F	10F	455.9	1918	
G22216L	G22416L	35	10F	26 1/2	17 3/4	17 1/4	8F	25 5/8	17	22	29 1/2	11 1/2	82 3/8	17 1/2	17 1/2	96 1/2	10F	10F	527.3	2132	
G22218L	G22418L	35	10F	26 1/2	17 3/4	17 1/4	8F	25 5/8	17	22	29 1/2	11 1/2	94 3/8	17 1/2	17 1/2	108 1/2	10F	10F	598.8	2316	
G22220L	G22420L	35	10F	26 1/2	17 3/4	17 1/4	8F	25 5/8	17	22	29 1/2	11 1/2	106 3/8	17 1/2	17 1/2	120 1/2	10F	10F	670.2	2500	

MATERIALS OF CONSTRUCTION (Unless otherwise indicated, standard will be furnished.)

	Standard	Optional
Shell	Steel	304ss, 316ss
Head	Cast Iron 4-10"	Fabricated Steel, Cast Bronze, Fabricated 304ss/316ss
	Fabricated Steel 12-30"	Cast Bronze, Fabricated 304ss/316ss
Tubes	3/4 x 20 BWG Copper	3/4 x 18 BWG Copper, Steel, 304ss, 316ss, 90/10 Cu Ni, Admiralty
Tube Sheet	Steel	Bronze, Brass, 304ss, 316ss, 90/10 Cu Ni
Separators	Steel	Bronze, Brass, 304ss, 316ss, 90/10 Cu Ni
Working Pressure	150 PSIG (ASME)	Consult Factory
Max. Temperature	375°F	Consult Factory

All dimensions shown are subject to change and should not be used for pre-piping. Contact your local Taco representative should certified dimensional drawings be required.

