



Submittal Data Information

U Tube Heat Exchangers

201-016

22" DIAMETER STEAM

EFFECTIVE: APRIL 15, 1995

Job: _____

Item No.	Model No.	Pass	GPM Tubes	Temp. In	Temp. Out	Steam Pressure Shell	Pressure Drop Tubes	Velocity Tubes

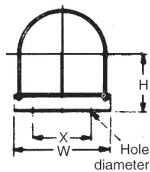

SADDLES
(Optional)

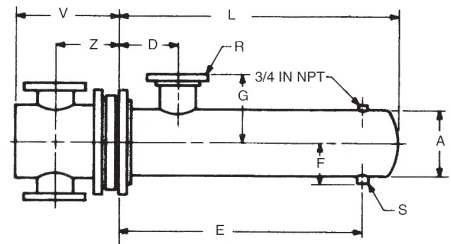
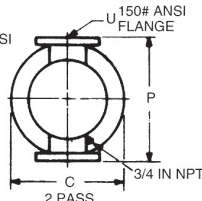
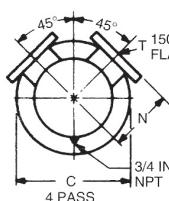

DIMENSIONS

22 Inch Diameter

Model Number		Fabricated Steel Heads								Dimensions (inches)										Heating Surface (sq. ft.)	Shipping Weight (lbs.)		
2 Pass	4 Pass	2 Pass				4 Pass				2 and 4 Pass													
		P	U	V	Z	N	T	V	Z	A	C	D	E	F	G	L	R	S					
G22206S	G22406S	35	10F	26½	17¾	17¼	8F	24½	17	22	29½	14	25.38	16	17	38.62	12F	4F	193.5	1212			
G22208S	G22408S	35	10F	26½	17¾	17¼	8F	24½	17	22	29½	14	37.38	16	17	50.62	12F	4F	265.0	1396			
G22210S	G22410S	35	10F	26½	17¾	17¼	8F	24½	17	22	29½	14	49.38	16	17	62.62	12F	4F	336.5	1580			
G22212S	G22412S	35	10F	26½	17¾	17¼	8F	24½	17	22	29½	14	61.38	16	17	74.62	12F	4F	408.0	1764			
G22214S	G22414S	35	10F	26½	17¾	17¼	8F	24½	17	22	29½	14	73.38	16	17	86.62	12F	4F	479.5	1948			
G22216S	G22416S	35	10F	26½	17¾	17¼	8F	24½	17	22	29½	14	85.38	16	17	98.62	12F	4F	551.0	2132			
G22218S	G22418S	35	10F	26½	17¾	17¼	8F	24½	17	22	29½	15	97.38	16	18	110.62	14F	4F	622.5	2316			
G22220S	G22420S	35	10F	26½	17¾	17¼	8F	24½	17	22	29½	15	109.38	16	18	122.62	14F	4F	694.0	2500			

SADDLE DIMENSIONS: H-17; W-25; X-18; Hole Dia.-7/8.

MATERIALS OF CONSTRUCTION (Unless otherwise indicated, standard will be furnished.)

	Standard	Optional
Shell	Steel	304ss, 316ss
Head	Cast Iron 4-10"	Fabricated Steel, Cast Bronze, Fabricated 304ss/316ss
	Fabricated Steel 12-30"	Cast Bronze, Fabricated 304ss/316ss
Tubes	3/4 x 20 BWG Copper	3/4 x 18 BWG Copper, Steel, 304ss, 316ss, 90/10 Cu Ni, Admiralty
Tube Sheet	Steel	Bronze, Brass, 304ss, 316ss, 90/10 Cu Ni
Separators	Steel	Bronze, Brass, 304ss, 316ss, 90/10 Cu Ni
Working Pressure	150 PSIG (ASME)	Consult Factory
Max. Temperature	375°F	Consult Factory

All dimensions shown are subject to change and should not be used for pre-piping. Contact your local Taco representative should certified dimensional drawings be required.

Do it Once. Do it Right.

Taco, Inc., 1160 Cranston Street, Cranston, RI 02920 Telephone: (401) 942-8000 Fax: (401) 942-2360
Taco (Canada), Ltd., 6180 Ordan Drive, Mississauga, Ontario L5T 2B3 Telephone: (905) 564-9422 Fax: (905) 564-9436
Visit our website at: www.taco-hvac.com

Printed in USA
Copyright 2007
TACO, Inc.