

SKS Series Pump | Submittal Data

Submittal No: 301-S113 | Model: SKS1506D | RPM: 3500 | HP: 10HP | Effective: April 24, 2020 | Supersedes: January 27, 2020

JOB: _____

REPRESENTATIVE: _____

ENGINEER: _____

CONTRACTOR: _____

PRODUCT DATA

ITEM NO. _____

DOE BASIC MODEL NO. SKS1506D-A-2P-PD

MODEL NO. _____ VOLTAGE _____

PEI_{VL} 0.41 HI ENERGY RATING 59

IMPELLER DIA. _____ WEIGHT _____

GPM _____ PUMP/MOTOR _____

HEAD/FT _____ FREQUENCY _____

RPM 3500 HP 10 PHASE _____

NSF 61 CERTIFIED* YES NO SUPPORT STAND OPTION YES NO
*Not configurable as a standard option; please contact your account manager to configure.
 (Ductile Iron ASTM A536-84 Grade 65-45-12)

OPERATING SPECIFICATIONS

| FLANGE | PRESSURE | TEMPERATURE |
|----------------|-----------------------|---------------|
| ANSI Class 125 | 175 PSIG* (1210 KPA) | 250°F (120°C) |
| ANSI Class 250 | 300 PSIG** (2070 KPA) | 250°F (120°C) |

* In accordance with ANSI Standard B16.1 Class 125

** In accordance with ANSI Standard B16.1 Class 250

DIMENSIONS

Model No. | 1506D

Flange Size (Suction x Discharge) | 1 ½ x 1 ½ (38 x 38)

| | |
|--|----------------------------|
| HORSEPOWER | 10 |
| MOTOR FRAME TEFC | 215TC |
| MOTOR FRAME ODP | 213TC |
| WEIGHT WITHOUT OPTIONAL STAND LBS (KG) | 390 (177) |
| WEIGHT WITH OPTIONAL STAND LBS (KG) | 401 (182) |
| FLANGE SIZE ASA | 1.5 (38) |
| A* | ANSI CLASS 125: 7.5 (191) |
| | ANSI CLASS 250: 7.75 (197) |
| B* | ANSI CLASS 125: 7.5 (191) |
| | ANSI CLASS 250: 7.75 (197) |
| C | 4.68 (119) |
| E MAX | 43.48 (1104) |
| F MAX | 20.00 (508) |
| G | 5.00 (127) |
| J MAX | 22.42 (569) |
| K | 2 |
| L | 5/16-18 |
| M | 1.75 (44) |
| N | 6 (152) |
| P | 7.5 (191) |
| Q | 0.63 (16) |
| R | 6 (152) |

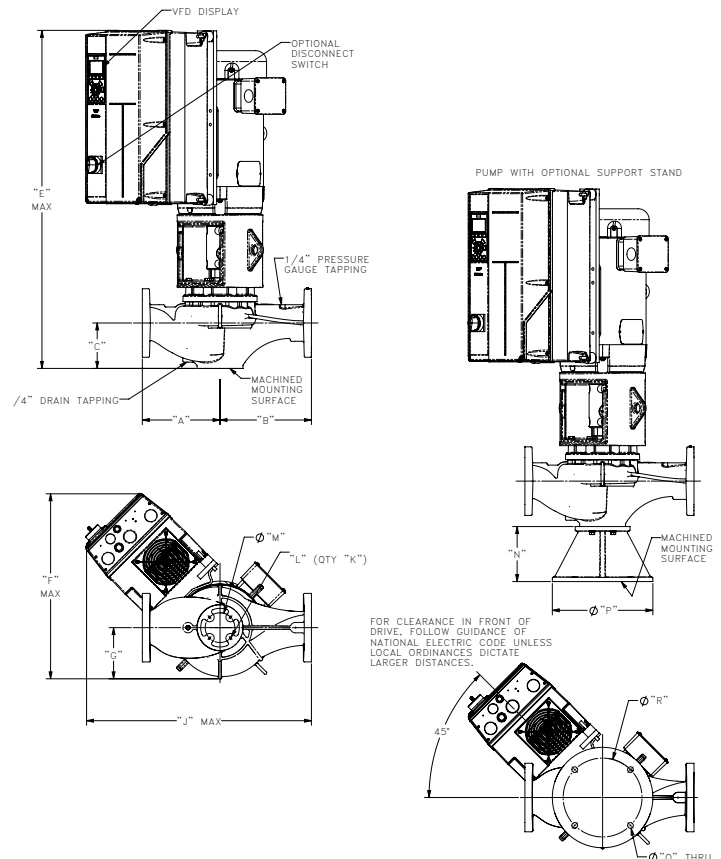

*A & B Dimensions apply for all pump sizes.

English dimensions are in inches. Metric dimensions are in millimeters.

Metric data is presented in (). Do not use for construction purposes unless certified.

| MATERIALS OF CONSTRUCTION | | | CASING | COVER | IMPELLER | WEAR RING | SHAFT | COUPLING | MECHANICAL SEAL | SEAL FLUSH LINE ASSEMBLY | SUPPORT STAND |
|---------------------------|---------------|--------------|---|--------------------------------------|---|-----------------------------|---------------------------------------|------------------------|---|--------------------------|--|
| STANDARD CONSTRUCTION | BRONZE FITTED | 125# FLANGE | Cast Iron ASTM A48/A48M-03 Class 30A | Cast Iron ASTM A48/A48M-03 Class 30A | Bronze ASTM B584 ALLOY C83600 or C84400 | N/A | Stainless Steel TYPE 416"™" ASTM A582 | Aluminum Alloy 6061-T6 | Ceramic/EPT | Copper & Brass C3600 | N/A |
| | | 250# FLANGE | Ductile Iron ASTM A536-84 Grade: 65-45-12 | Cast Iron ASTM A48/A48M-03 Class 30A | Bronze ASTM B584 ALLOY C83600 or C84400 | N/A | Stainless Steel TYPE 416"™" ASTM A582 | Aluminum Alloy 6061-T6 | Ceramic/EPT | Copper & Brass C3600 | N/A |
| OPTIONAL | | 125# OR 250# | N/A | N/A | Stainless Steel ASTM A351/A 351M-08 | Bronze ASTM B584-98A C92200 | N/A | N/A | Tungsten Carbide/EPT or Silicon-Carbide/EPT | N/A | Ductile Iron ASTM A536-84 Grade 65-45-12 |
| STANDARD CONSTRUCTION | NSF 61 | 125# FLANGE | Cast Iron ASTM A48/A48M-03 Class 30A | Cast Iron ASTM A48/A48M-03 Class 30A | Stainless Steel ASTM A351/A 351M-08 | N/A | Stainless Steel TYPE 416"™" ASTM A582 | Aluminum Alloy 6061-T6 | Ceramic/EPT | Copper & Brass C3600 | N/A |
| | | 250# FLANGE | Ductile Iron ASTM A536-84 Grade: 65-45-12 | Cast Iron ASTM A48/A48M-03 Class 30A | Stainless Steel ASTM A351/A 351M-08 | N/A | Stainless Steel TYPE 416"™" ASTM A582 | Aluminum Alloy 6061-T6 | Ceramic/EPT | Copper & Brass C3600 | N/A |
| OPTIONAL | | 125# OR 250# | N/A | N/A | N/A | Bronze ASTM B584-98A C92200 | N/A | N/A | N/A | N/A | Ductile Iron ASTM A536-84 Grade 65-45-12 |

N/A - Not Available

DRIVE DATA

| | |
|----------------------------|--|
| PROTOCOLS (Standard) | BACnet, Modbus RTU, N2 Metasys, FLN Apogee, FC Protocol |
| PROTOCOLS (Optional) | LonWorks® DeviceNet Profibus |
| ENCLOSURE | NEMA Type 12 / IP55 NEMA Type 4X / IP66 |
| I/O (Standard) | 6 Digital Inputs / 2 Digital Outputs 1 Analog Current Output / 2 Analog Inputs 2 Pulse Inputs 2 Form C Relays |
| ADDITIONAL CONTROL OPTIONS | None General Purpose I/O Relay Card 24VDC Supply Analog I/O |
| DISCONNECT SWITCH | Mechanical Fused |
| EMC/RFI CONTROL | Intergated filter designed to meet EN61800-3 |
| HARMONIC SUPPRESSION | Dual DC-link chokes (Equivalent: 5% AC line reactor) Supporting IEEE 519-1992 requirements |
| COOLING | Fan-cooled through back channel |
| AMBIENT TEMPERATURE | -10°C to 45°C up to 1000 meters above sea level -14°F to 113°F up to 3300 feet above sea level |

COMMENTS

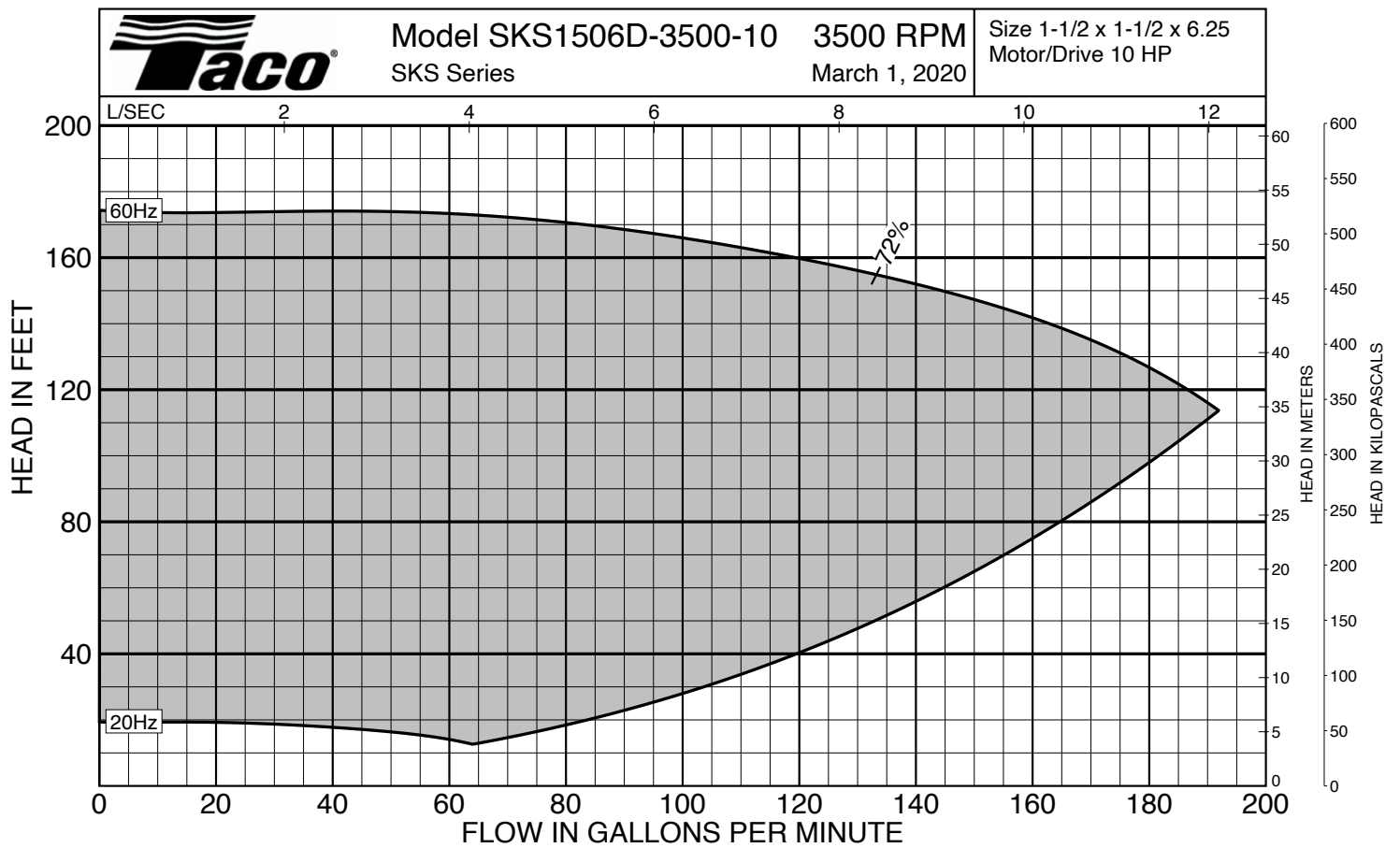

Curves based on Clear Water @ 60F with a Specific Gravity of 1.0