

Replacement Parts List

Rotating Elements

304-534

For Models HS060509, HS060511, HS060512 & HS060515

SUPERSEDES: NEW

EFFECTIVE: August 10, 2016

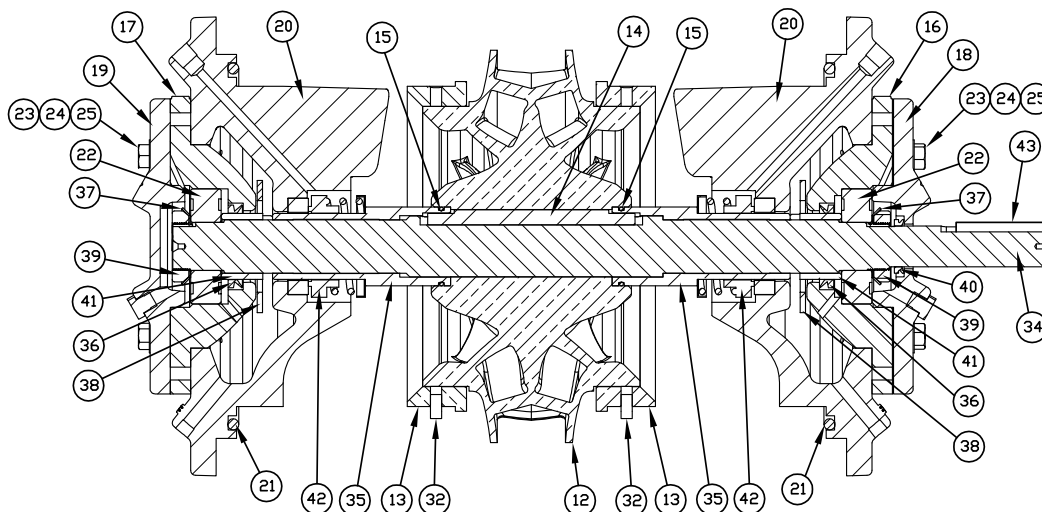

ITEM NO.	QTY. REQ.	DESCRIPTION	PART NUMBERS			
			PUMP MODEL HS060509	PUMP MODEL HS060511	PUMP MODEL HS060512	PUMP MODEL HS060515
12	1	IMPELLER (BRONZE)	974-1031RP	974-1082RP	974-1052RP	974-1059RP
13	2	WEAR RING (BRONZE)	974-1032RP	974-1083RP	974-1032RP	974-1075RP
14	1	IMPELLER KEY (CARBON STEEL)		974-1088RP		974-1086RP
14	1	IMPELLER KEY (STAINLESS STEEL)		974-1089RP		974-1087RP
15	2	O-RING, SLEEVE		951-176RP		974-2564RP
16	1	BEARING HOUSING (DRIVE END)		974-1035RP		974-1062RP
17	1	BEARING HOUSING (NON-DRIVE END)		974-1036RP		974-1063RP
18	2	CAP, BEARING HOUSING (DRIVE END)		974-1037RP		974-1064RP
19	2	CAP, BEARING HOUSING (NON-DRIVE END)		974-1038RP		974-1065RP
20	2	COVER, 125#	974-1033RP	974-1080RP	974-1033RP	974-1060RP
20	2	COVER, 250#	974-1034RP	974-1081RP	974-1034RP	974-1061RP
21	1	O-RING, COVER		974-1047RP		
22	2	BALL BEARING-SEALED		820-1039RP		953-2215RP
23	8	3/8 x 1.75 HEX BOLT, CAP		10-283RP		
24	32	3/8 WASHER, CAP & COVER		14-315RP		
25	24	3/8 x 1.50 HEX BOLT, CAP & COVER		10-227RP		
32	2	PIN, CASING ALIGNMENT		17-1418RP		
34	1	SHAFT (CARBON STEEL)		974-1039RP		974-1066RP
34	1	SHAFT (STAINLESS STEEL)		974-1040RP		974-1067RP
35	2	SLEEVE (BRONZE)		974-1041RP		974-1068RP
36	2	V-RING (SLEEVE)		953-1575-7RP		953-1575-8RP
37	2	LOCK WASHER (BEARING)		951-2515RP		951-2516RP
38	2	SLINGER RING		951-1971RP		951-2522RP
39	2	ROUND SLOTTED NUT (BEARING)		974-1018RP		974-1072RP
40	1	V-RING (SHAFT)		953-1575-2RP		953-1575-7RP
41	2	BUSHING, BEARING SLEEVE SPACER		974-1042RP		974-1069RP
43	1	KEY, COUPLER		13-128RP		13-127RP

AW-1145 Rev 1

