

Replacement Parts List

Seal

304-531

For Models HS060509, HS060511, HS060512 & HS060515

SUPERSEDES: NEW

EFFECTIVE: August 10, 2016

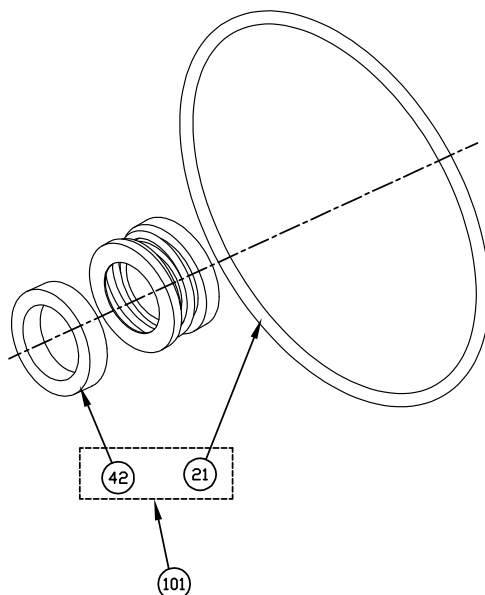

AW-1142 Rev 2

WORKING PRESSURE	SEAL DESIGN	ITEM NO.	QTY. REQ.	DESCRIPTION	PART NUMBERS			
					PUMP MODEL HS060509	PUMP MODEL HS060511	PUMP MODEL HS060512	PUMP MODEL HS060515
125#	B	101	1	SEAL KIT	974-2079RP			974-2080RP
		21	1	O-RING, COVER	974-1047RP			
		42	1	SEAT & SEAL ASSEMBLY	950-673RP			950-674RP
	D	101	1	SEAL KIT	974-2081RP			974-2082RP
		21	1	O-RING, COVER	974-1047RP			
		42	1	SEAT & SEAL ASSEMBLY	950-676RP			950-677RP
	E	101	1	SEAL KIT	974-2091RP			974-2092RP
		21	1	O-RING, COVER	974-1047RP			
		42	1	SEAT & SEAL ASSEMBLY	950-679RP			950-680RP
250#	B	101	1	SEAL KIT	974-2093RP			974-2094RP
		21	1	O-RING, COVER	974-1047RP			
		42	1	SEAT & SEAL ASSEMBLY	951-3768RP			951-4182RP
	D	101	1	SEAL KIT	974-2095RP			974-2096RP
		21	1	O-RING, COVER	974-1047RP			
		42	1	SEAT & SEAL ASSEMBLY	951-3783RP			951-4185RP
	E	101	1	SEAL KIT	974-2097RP			974-2098RP
		21	1	O-RING, COVER	974-1047RP			
		42	1	SEAT & SEAL ASSEMBLY	951-3784RP			951-4186RP

